

SIGNIFICANT WORK

Select Design Projects



Central National Bank Rehabilitation

Richmond, VA / Commonwealth Architects / 2016 Completion

Role: Project Principal & Project Manager

Located on Broad Street in Richmond, Virginia, the rehabilitation of the Central National Bank will bring new life to one of the city's most iconic towers. Thanks largely to Mills' efforts to steer key decision-makers toward a successful outcome, this adaptive reuse project will provide a mixed-use community blending apartments tailored to students and young professionals with commercial and retail uses. Listed on the National Register of Historic Places, the building contributes to the Grace Street Commercial Historic District and is an anchor in the revitalization of the surrounding area.



The Chamberlin

Fort Monroe, VA / Commonwealth Architects / 2008 Completion

Role: Project Principal

The Chamberlin, built in 1928, was once a grand hotel facing the Hampton Roads harbor at the mouth of the Chesapeake Bay. In 2008, the rehabilitation of the Chamberlin (phase I) was completed for use as an Independent Living component of the senior living community. On an adjacent lot, a new, compatible infill building has been designed for a future assisted living component with parking deck.



Danville Masonic Temple Hotel

Danville, VA / Commonwealth Architects / 2017 Completion

Role: Project Principal & Project Manager

The rehabilitation of Danville, Virginia's tallest structure, the historic Masonic Temple Building, will provide a boutique hotel and conference center with space for events, banquets, and a restaurant. A new mixed-use, infill building is proposed across Main Street to provide off-site parking for the hotel, provide public parking spaces for the City of Danville, and create new retail space. This new hotel and conference center will not only incorporate the rehabilitation of one of Danville's significant buildings but will also serve as an economic driver for one of Virginia's historic downtowns.



Blackburn Inn & Spa

Staunton, VA / Commonwealth Architects / 2017 Completion

Role: Project Principal & Project Manager

The adaptive reuse of three historic buildings on the former Western State Hospital campus into the Blackburn Inn & Spa will be the focal point of the 80-acre Villages at Staunton mixed-use development. Comprised of three architecturally significant structures, the Blackburn Inn & Spa is planned as a 103-room destination boutique hotel, conference center, and spa. The 8,000 square-foot spa will include an adjacent spa garden offering comprehensive fitness, spa and wellness programs. The Blackburn Inn & Spa will be the centerpiece of this community development plan for Staunton.



Maury School Rehabilitation

Fredericksburg, VA / Commonwealth Architects / 2007

Role: Project Principal

After standing vacant for 26 years, the rehabilitation of the former Maury School in downtown Fredericksburg transformed the building into residential units and the Central Rappahannock Heritage Center. Mills led the team that converted a boarded-up liability into a tax-generating asset for the city. Located within local, state, and national historic districts, the rehabilitation has had a widespread positive impact on improvement to adjacent structures in the neighborhood.

SIGNIFICANT WORK

Select Design Projects



8th & 9th Street Project

Richmond, VA / Commonwealth Architects / 2014 Completion, Phase I

Role: Project Principal

The rehabilitation of the Ninth Street Office Building for the Virginia Department of General Services is located at the gateway to Virginia's Capitol Square. The future headquarters for the Office of the Attorney General, the existing building will deliver unique solutions to meet the programmatic needs for the "Commonwealth's law firm." Mills brought together community leaders with divergent views to reach consensus on the preliminary design of the overall project. He led the team that combined a thoughtful restoration of the 9th Street building with the contemporary needs of a modern office building. The overall design is sensitive to the site's history and preserves the aesthetic and historic fabric of Capitol Square.



Washington Building Rehabilitation

Capitol Square, Richmond, VA / Commonwealth Architects / 2009

Role: Project Principal

Built in 1924 as the "State Office Building," the Washington Building anchors the southeast corner of Richmond's Capitol Square, offering dramatic views of Jefferson's State Capitol. The uppermost level of the building's exterior features an exceptionally ornate terra cotta finish that continues to a large sweeping cornice, the signature element of the structure. The rehabilitation of this prominent building brought new vitality to Capitol Square.



November Theatre Rehabilitation

City Center, Richmond, VA / Commonwealth Architects / 2014

Role: Project Principal

The restored façade of what is probably Virginia's oldest theatre structure revitalizes the stretch of Broad Street where it is located with its mix of galleries, restaurants and businesses. This project restored a major historic building with a community function and a highly visible street presence. Virginia Repertory Theatre is a vital part of the Richmond arts community and brings quality theater experiences to local audiences. Mills helped forge a partnership between the Virginia Repertory Theatre, the City of Richmond, nearby businesses and the Virginia Department of Historic Resources to restore the façade of the Sara Belle and Neil November Theatre to its original glory.



Berry Burk Rehabilitation

City Center, Richmond, VA / Commonwealth Architects / 2006

Role: Project Principal

Mills' leadership resulted in the rehabilitation of one of the first buildings on its block in downtown Richmond and consequently served as a catalyst for rebirth of the Grace Street state and national historic districts. Previously the home of The Berry-Burk Company, a retail clothing store built in 1928, the adaptive re-use of the building provides upscale, downtown living and urban retail space.

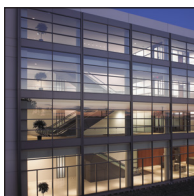

Anthem BlueCross Blue Shield Regional Headquarters

Richmond, VA / Commonwealth Architects / 2005

Role: Project Principal

Commonwealth Architects, in association with Perkin + Will, developed and implemented the master plan for Anthem's new Southeast corporate campus. Mills worked with Anthem to rehabilitate its existing headquarters building and to expand their facility through the design and construction of a new office building and parking deck. Rather than moving to a new suburban location, this solution stabilized the established commercial community in Mid-Town.